

The Taming of the Shrew	
Written By: William Shakespeare	
Ground Plan	SCALE: 1/8"=1'
Interlochen Shakespeare Festival- Harvey Theatre	PLATE:
Director: William Church	1
Scenic Designer: Christopher S. Dills	
Technical Director: Neil Carpentier-Alting	
Show Date: June 25 - July 5, 2009	
Updated On: 05-29-09	Revision #: 5
of 17	

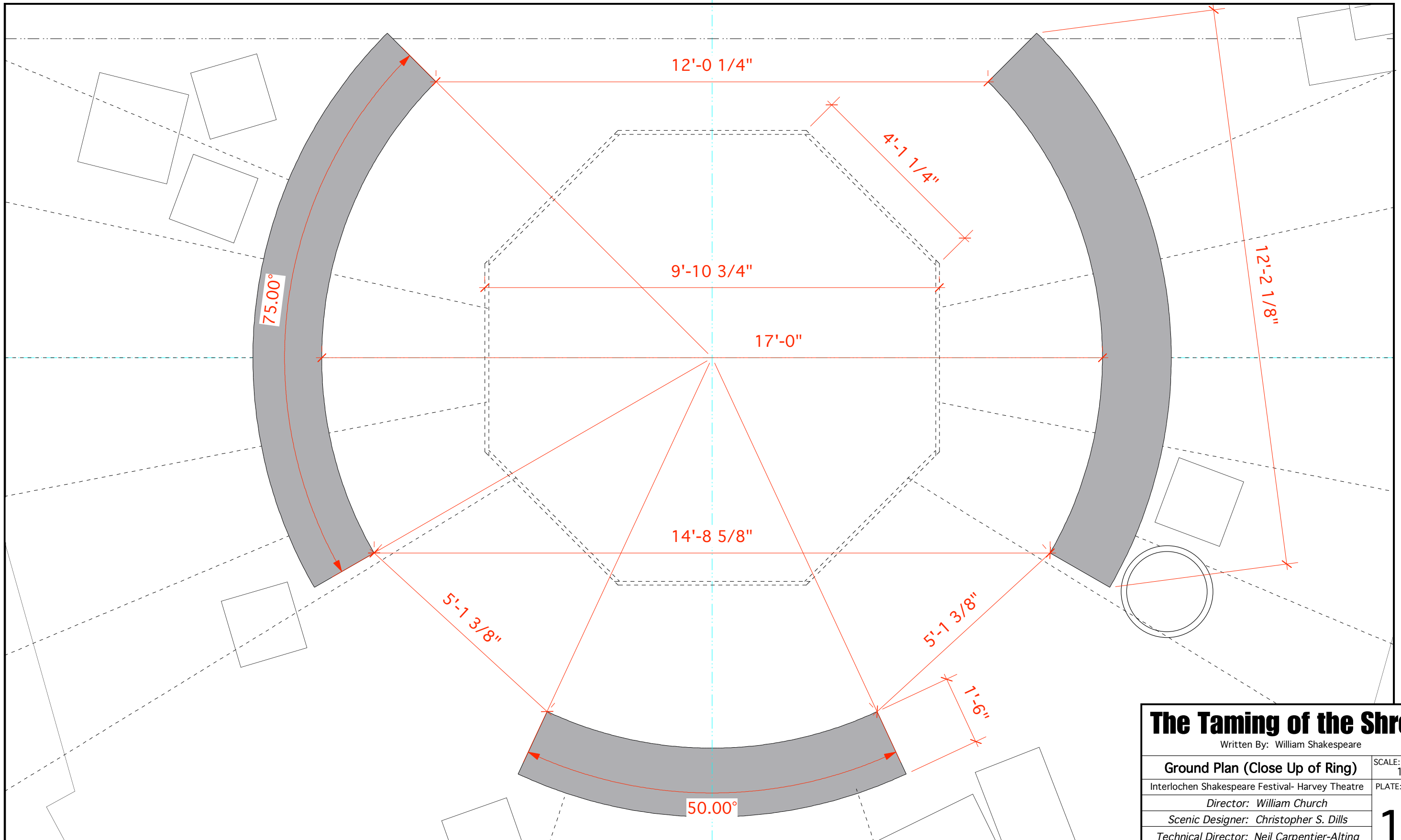

The Taming of the Shrew	
Written By: William Shakespeare	
Ground Plan (Close Up of Ring)	SCALE: 1/2"=1'
Interlochen Shakespeare Festival- Harvey Theatre	PLATE:
Director: William Church	1 B
Scenic Designer: Christopher S. Dills	
Technical Director: Neil Carpentier-Alting	of 17
Show Date: June 25 - July 5, 2009	
Updated On: 05-19-09	Revision #: 3

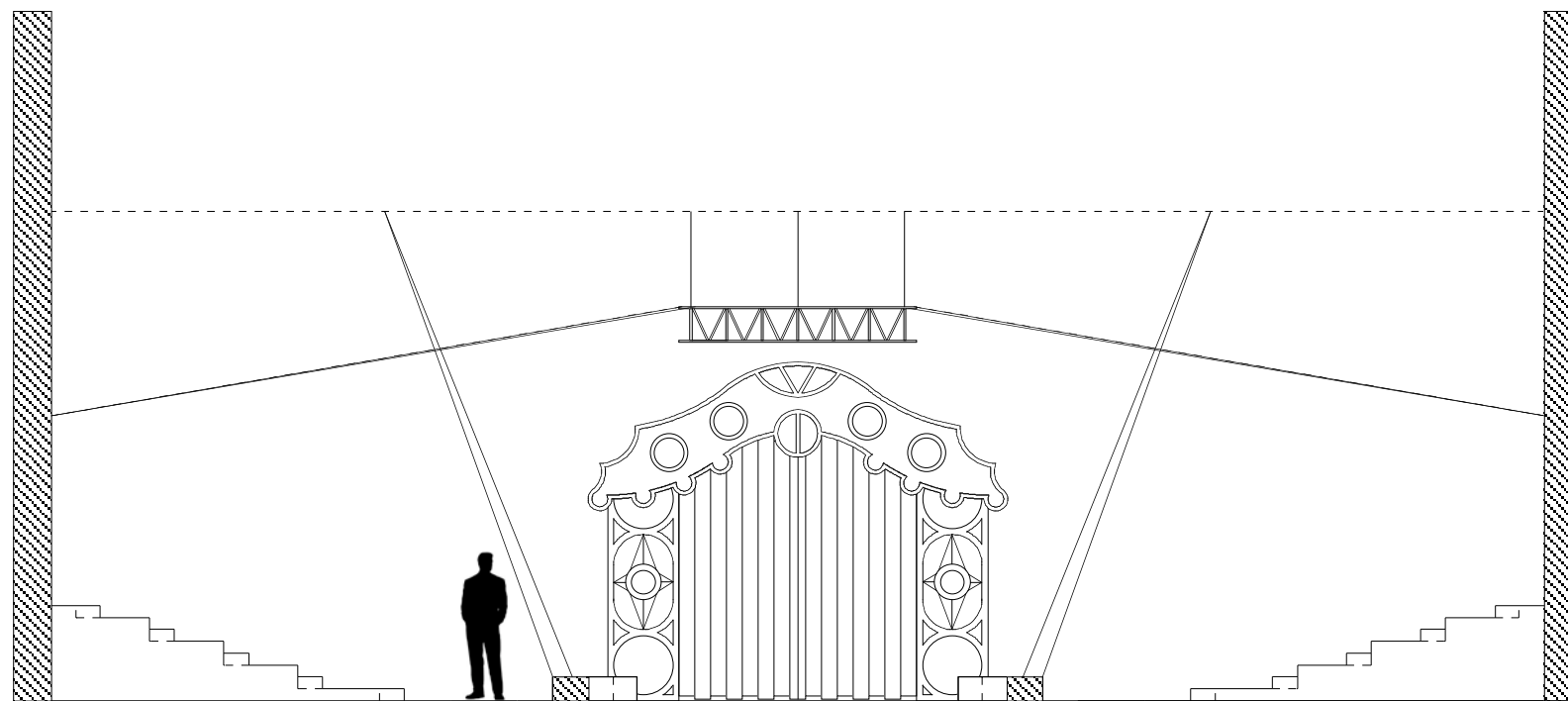

The Taming of the Shrew	
Written By: William Shakespeare	
Section View #4 (Upstage)	SCALE: 1/8"=1'
Interlochen Shakespeare Festival- Harvey Theatre	
<i>Director: William Church</i>	
<i>Scenic Designer: Christopher S. Dills</i>	
<i>Technical Director: Neil Carpentier-Alting</i>	
<i>Show Date: June 25 - July 5, 2009</i>	
<i>Updated On:</i> 05-11-09	<i>Revision #:</i> 1
2 of 17	

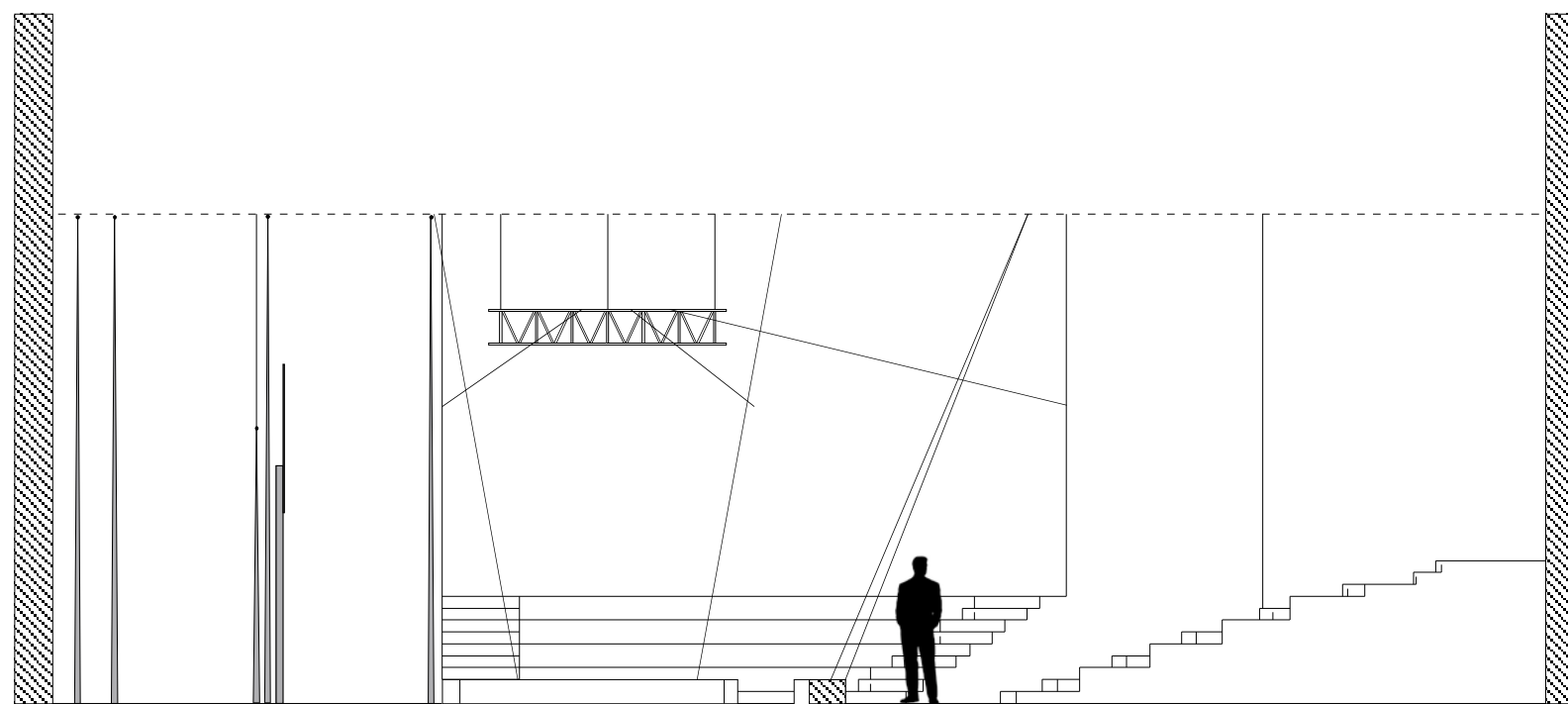

The Taming of the Shrew	
Written By: William Shakespeare	
Section View #3 (Stage Left)	SCALE: 1/8"=1'
Interlochen Shakespeare Festival- Harvey Theatre	PLATE:
Director: William Church	3
Scenic Designer: Christopher S. Dills	
Technical Director: Neil Carpentier-Alting	
Show Date: June 25 - July 5, 2009	of 17
Updated On: 05-11-09	

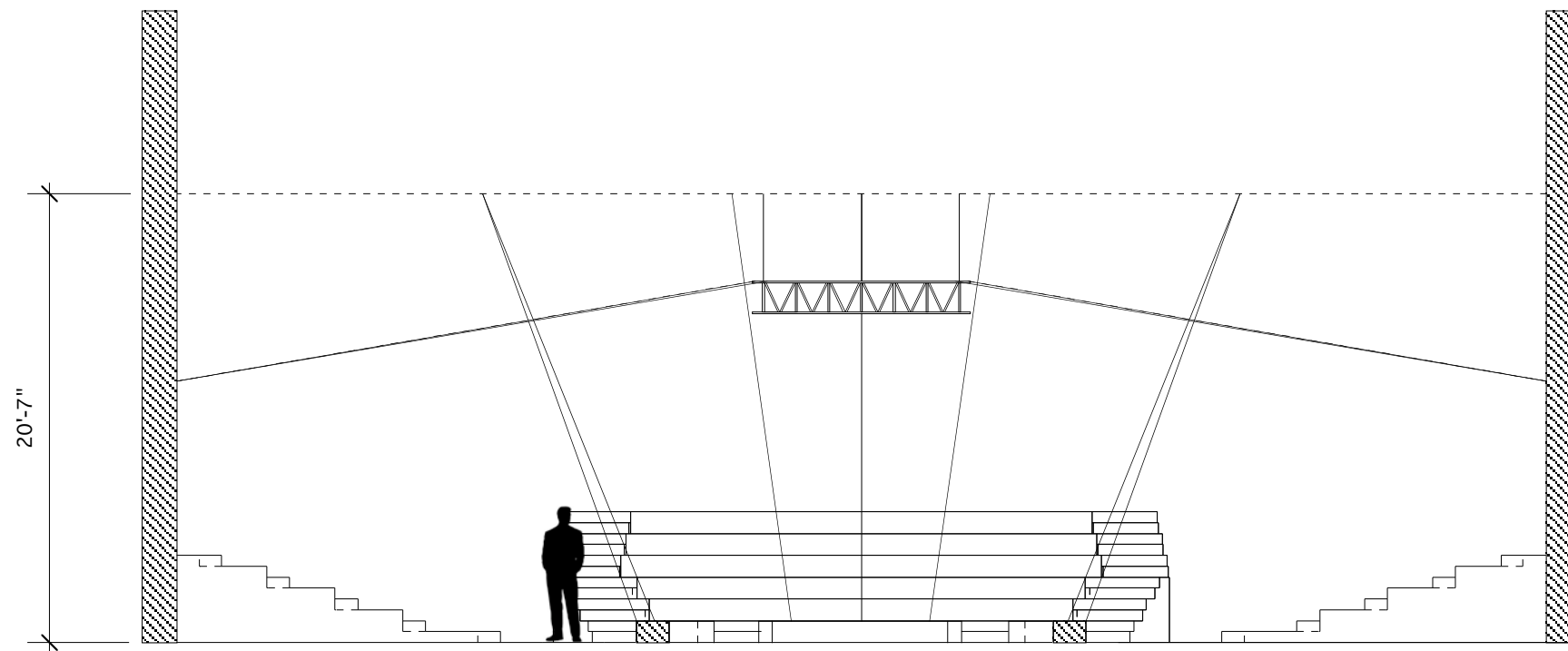

The Taming of the Shrew	
Written By: William Shakespeare	
Section View #1 (Downstage)	SCALE: 1/8"=1'
Interlochen Shakespeare Festival- Harvey Theatre	PLATE:
Director: William Church	4
Scenic Designer: Christopher S. Dills	
Technical Director: Neil Carpentier-Alting	
Show Date: June 25 - July 5, 2009	of 17
Updated On: 05-11-09 Revision #: 1	

TICKET BOOTH FRAME

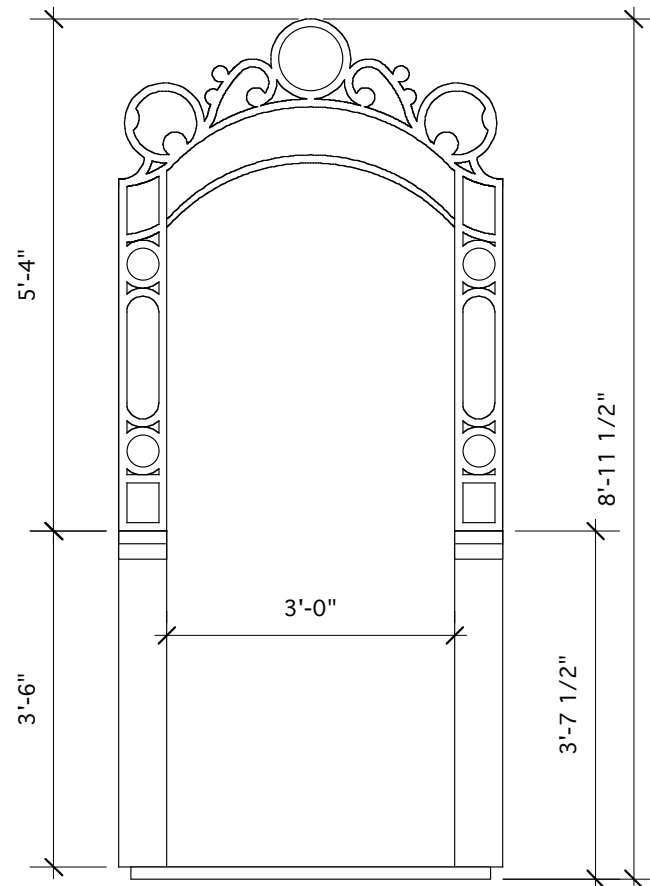

TICKET BOOTH (Door & Frame)

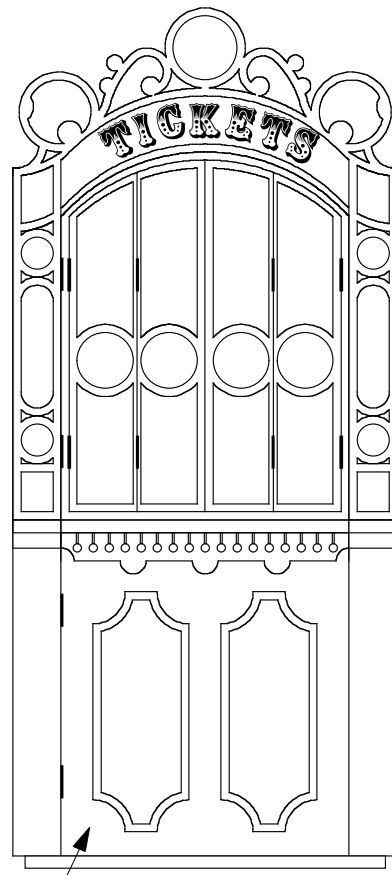

TICKET BOOTH DOOR (Top & Bottom)

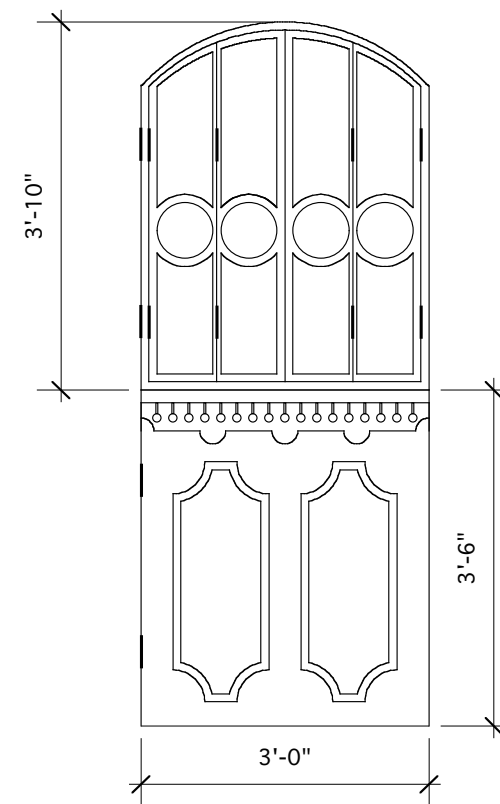

NOTES:

1. Details of the top of the frame and the door are on individual plates. Refer to them for more information.
2. Note that the ticket booth frame includes both the top cut out detail and the bottom portion that meets with the bottom half of the door.
3. The unit will be seen from all sides. The back is to be painted and treated but without the applied pieces on the front of the lower door unit.

Door size and frame might need to be adjusted according to the gap needed to make the hinges work and for the shelf/ledge to clear the frame of the booth.

The Taming of the Shrew	
Written By: William Shakespeare	
Ticket Booth Front Elevation	SCALE: 1/2"=1'
Interlochen Shakespeare Festival- Harvey Theatre	PLATE:
Director: William Church	5
Scenic Designer: Christopher S. Dills	
Technical Director: Neil Carpentier-Alting	
Show Date: June 25 - July 5, 2009	
Updated On: 4-16-09	Revision #: 0
of 17	

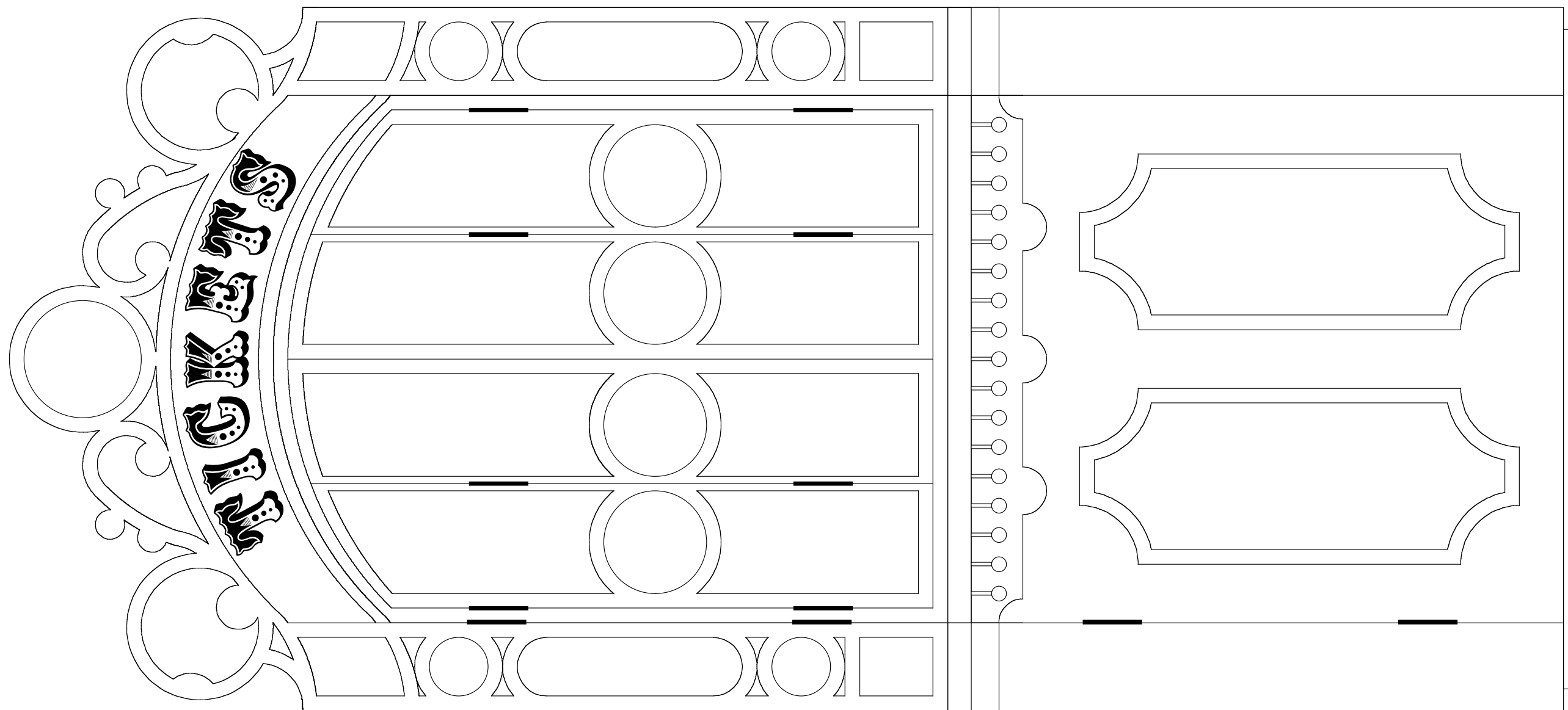

The Taming of the Shrew	
Written By: William Shakespeare	
T. Booth Front Elevation (Large)	SCALE: 1.5"=1'
Interlochen Shakespeare Festival- Harvey Theatre	PLATE:
<i>Director: William Church</i>	5B
<i>Scenic Designer: Christopher S. Dills</i>	
<i>Technical Director: Neil Carpentier-Alting</i>	
<i>Show Date: June 25 - July 5, 2009</i>	
<i>Updated On: 4-30-09</i>	<i>Revision #: 0</i>
of 17	

TICKET BOOTH
(Door & Frame)

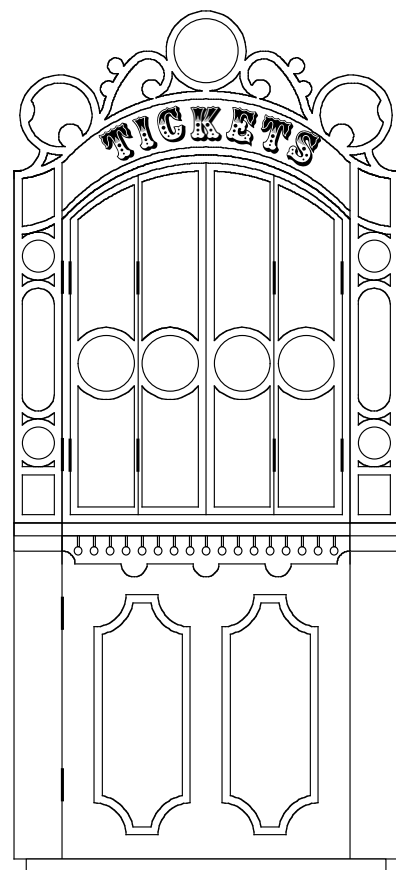

TICKET BOOTH
SECTION/SIDE VIEW

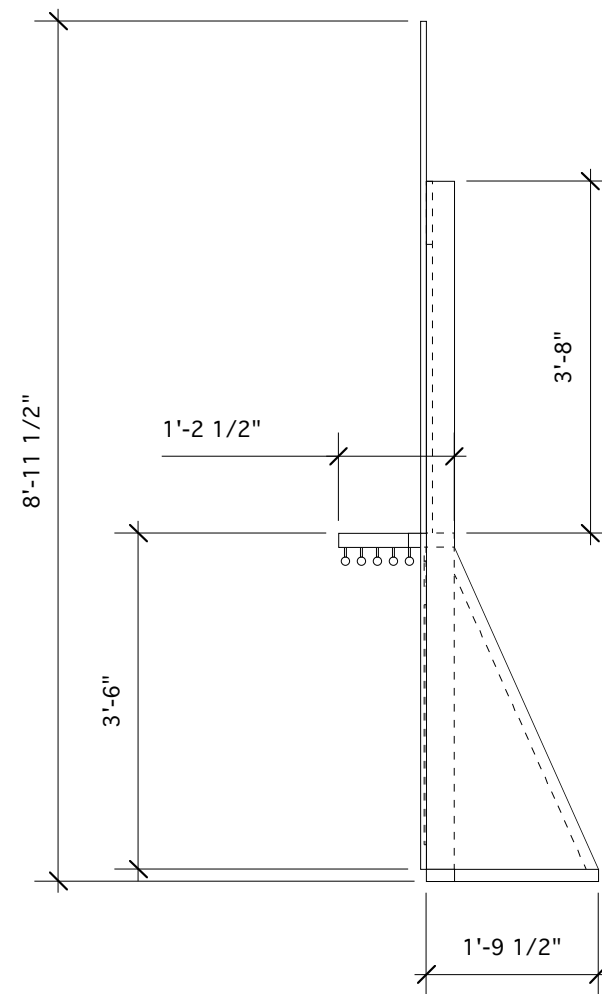

NOTES:

1. The entire ticket booth is to be on wheels. The unit might need a skirt around it to hide the wheels. The wheels should not be able to be seen.
2. The diagonal support should be weighted to keep the unit from being top heavy. The size can be adjusted as needed but should be as skinny/narrow as possible.
3. The door width, the frame opening, and/or the shelf/ledge will need to be adjusted to allow for the gap required for the door to open and operate like needed.

The Taming of the Shrew	
Written By: William Shakespeare	
Ticket Booth Section/Side View	SCALE: 1/2"=1'
Interlochen Shakespeare Festival- Harvey Theatre	PLATE:
<i>Director: William Church</i>	
<i>Scenic Designer: Christopher S. Dills</i>	
<i>Technical Director: Neil Carpentier-Alting</i>	
<i>Show Date: June 25 - July 5, 2009</i>	
<i>Updated On:</i> 03-10-09	<i>Revision #:</i> 0
6	
of 17	

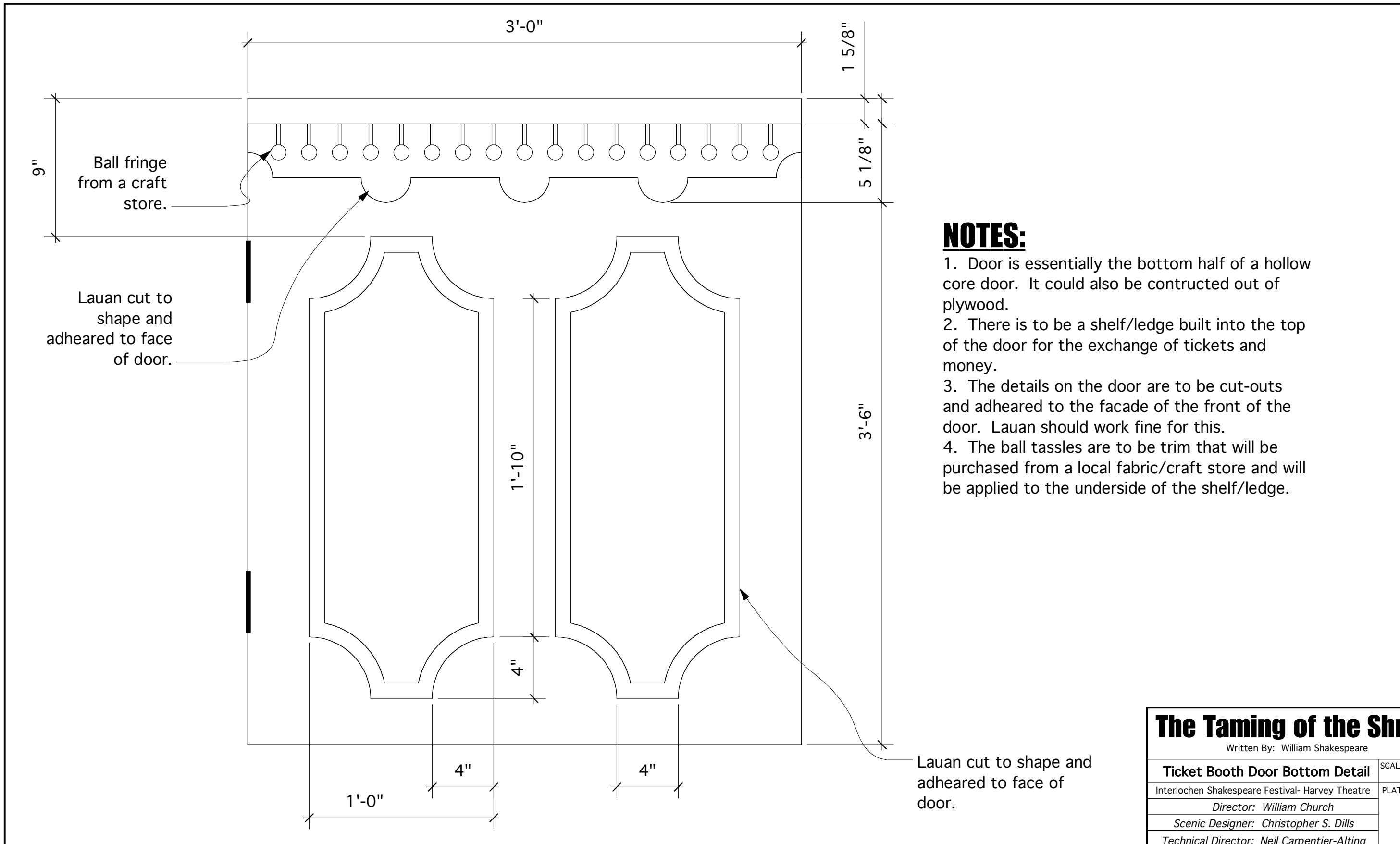

NOTES:

1. Door is essentially the bottom half of a hollow core door. It could also be constructed out of plywood.
2. There is to be a shelf/ledge built into the top of the door for the exchange of tickets and money.
3. The details on the door are to be cut-outs and adhered to the facade of the front of the door. Lauan should work fine for this.
4. The ball tassels are to be trim that will be purchased from a local fabric/craft store and will be applied to the underside of the shelf/ledge.

The Taming of the Shrew	
<small>Written By: William Shakespeare</small>	
Ticket Booth Door Bottom Detail	<small>SCALE: 2"=1'</small>
<small>Interlochen Shakespeare Festival- Harvey Theatre</small>	<small>PLATE:</small>
<small>Director: William Church</small>	7
<small>Scenic Designer: Christopher S. Dills</small>	
<small>Technical Director: Neil Carpentier-Alting</small>	
<small>Show Date: June 25 - July 5, 2009</small>	
<small>Updated On: 04-16-09</small>	<small>Revision #: 0</small>
<small>of 17</small>	

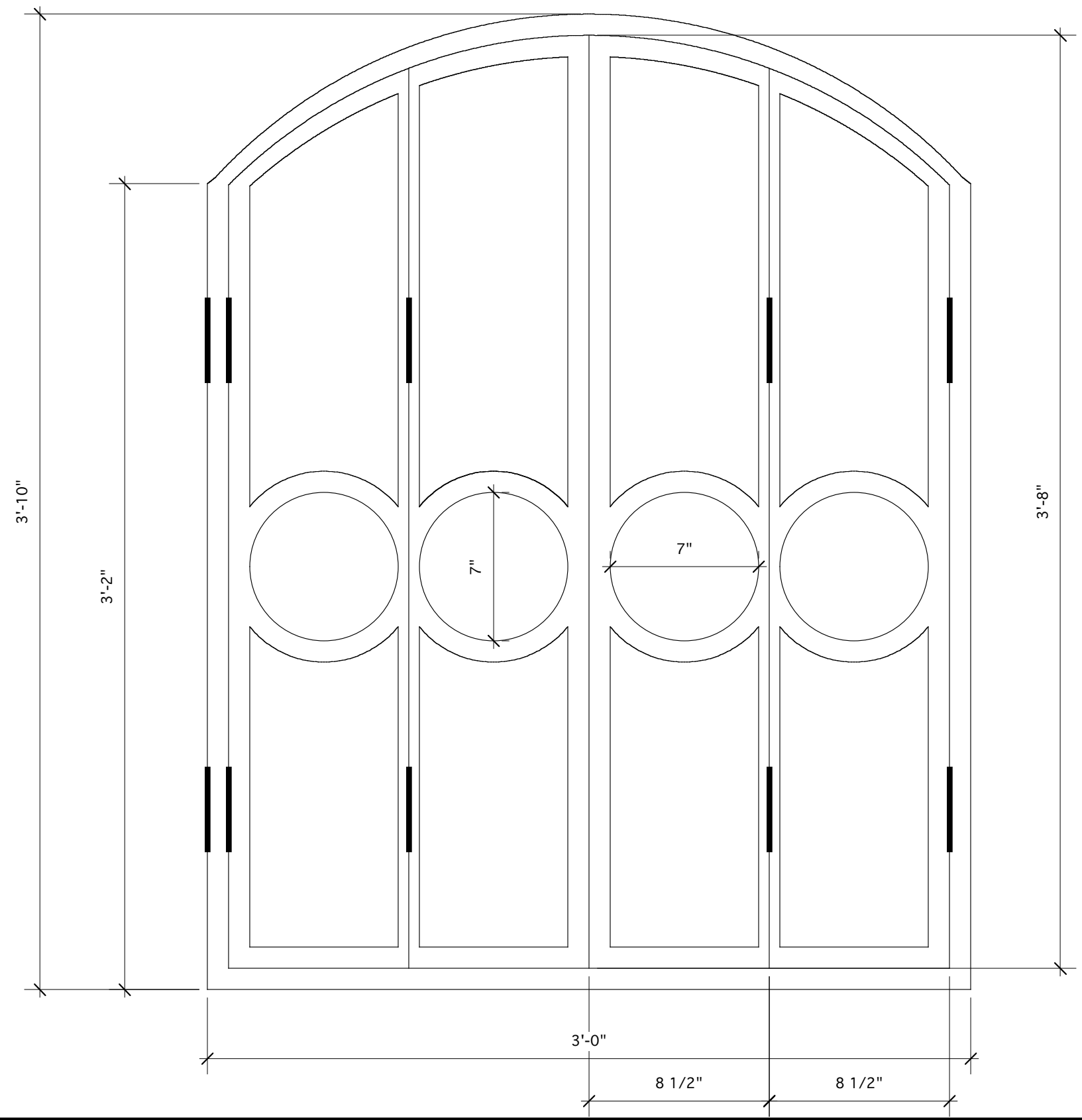

NOTES:

1. Inner doors to be opened accordian style to allow for "tickets" to be sold through the door.
2. Doors must latch together and to the bottom of the door, where the shelf/ledge is so that the two pieces (top and bottom) of the door unit can swing open as one to allow for actors to pass through.
3. Top of door is to be rounded in an arch that fits inside of the ticket booth door frame.
4. Gaps and distances between the accordian doors and the door unit and its fram must be taken into account. Gaps are not indicated on drafting and will depend on type and size of hinges acquired.

The Taming of the Shrew	
Written By: William Shakespeare	
Ticket Booth Door Top Detail	SCALE: 2"=1'
Interlochen Shakespeare Festival- Harvey Theatre	
Director: William Church	
Scenic Designer: Christopher S. Dills	
Technical Director: Neil Carpentier-Alting	
Show Date: June 25 - July 5, 2009	
Updated On: 04-16-09	Revision #: 0

8

of 17

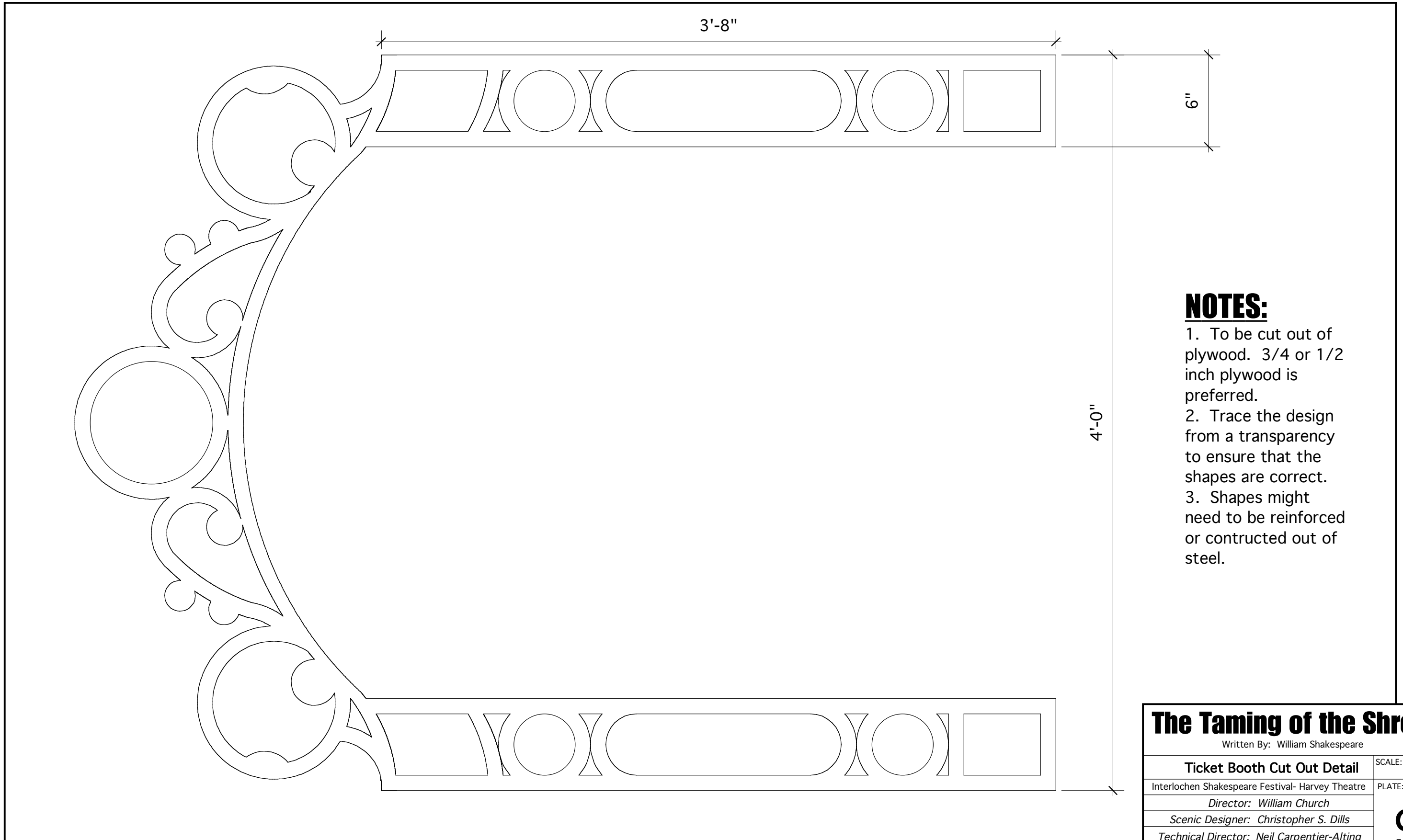

NOTES:

1. To be cut out of plywood. 3/4 or 1/2 inch plywood is preferred.
2. Trace the design from a transparency to ensure that the shapes are correct.
3. Shapes might need to be reinforced or constructed out of steel.

The Taming of the Shrew	
Written By: William Shakespeare	
Ticket Booth Cut Out Detail	SCALE: 2"=1'
Interlochen Shakespeare Festival- Harvey Theatre	
Director: William Church	
Scenic Designer: Christopher S. Dills	
Technical Director: Neil Carpentier-Alting	
Show Date: June 25 - July 5, 2009	
Updated On: 04-16-09	Revision #: 0
9	
of 17	

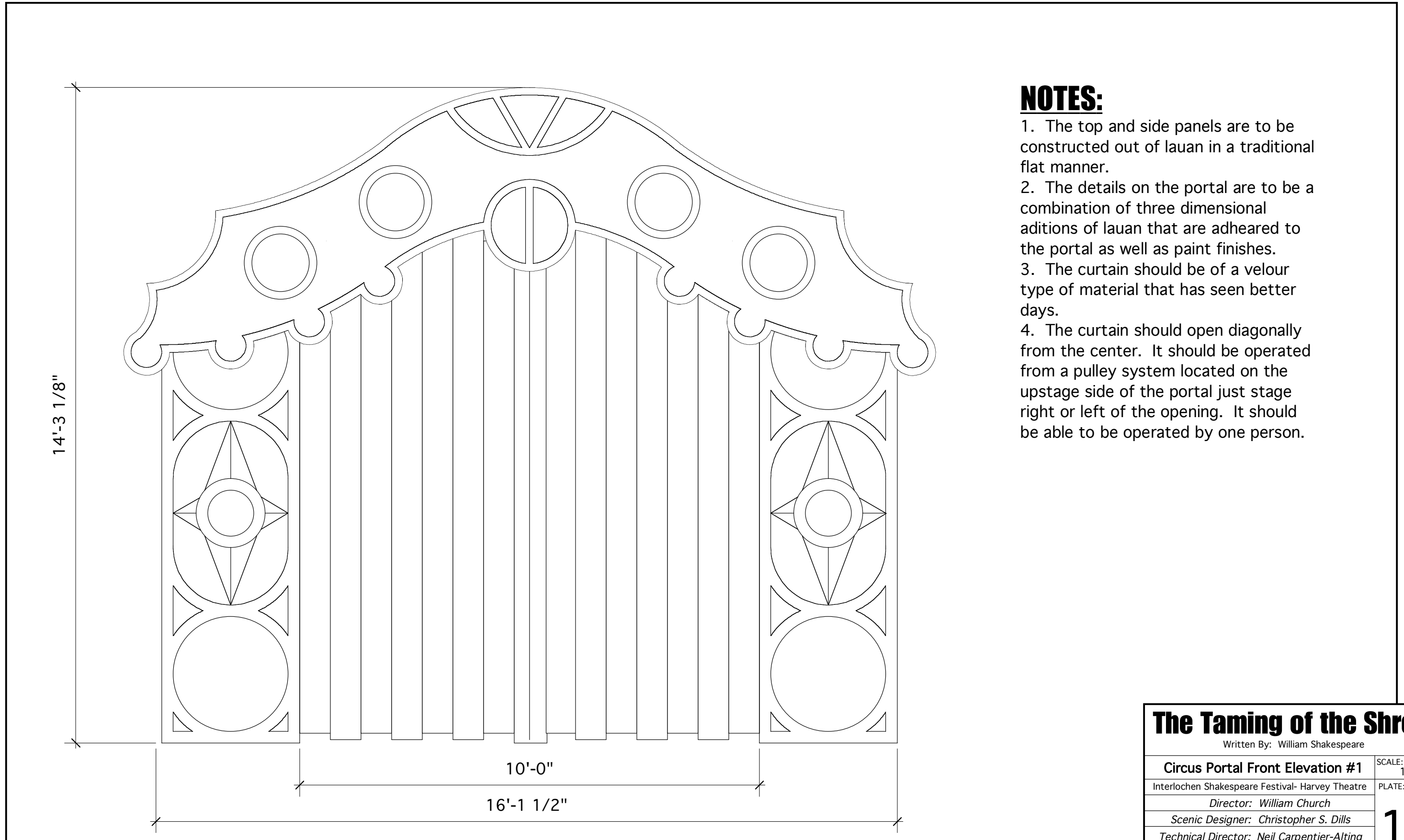

NOTES:

1. The top and side panels are to be constructed out of lauan in a traditional flat manner.
2. The details on the portal are to be a combination of three dimensional additions of lauan that are adhered to the portal as well as paint finishes.
3. The curtain should be of a velour type of material that has seen better days.
4. The curtain should open diagonally from the center. It should be operated from a pulley system located on the upstage side of the portal just stage right or left of the opening. It should be able to be operated by one person.

The Taming of the Shrew	
Written By: William Shakespeare	
Circus Portal Front Elevation #1	SCALE: 1/2"=1'
Interlochen Shakespeare Festival- Harvey Theatre	PLATE:
<i>Director: William Church</i>	
<i>Scenic Designer: Christopher S. Dills</i>	
<i>Technical Director: Neil Carpentier-Alting</i>	
<i>Show Date: June 25 - July 5, 2009</i>	
<i>Updated On:</i> 04-16-09	<i>Revision #:</i> 0
10	
of 17	

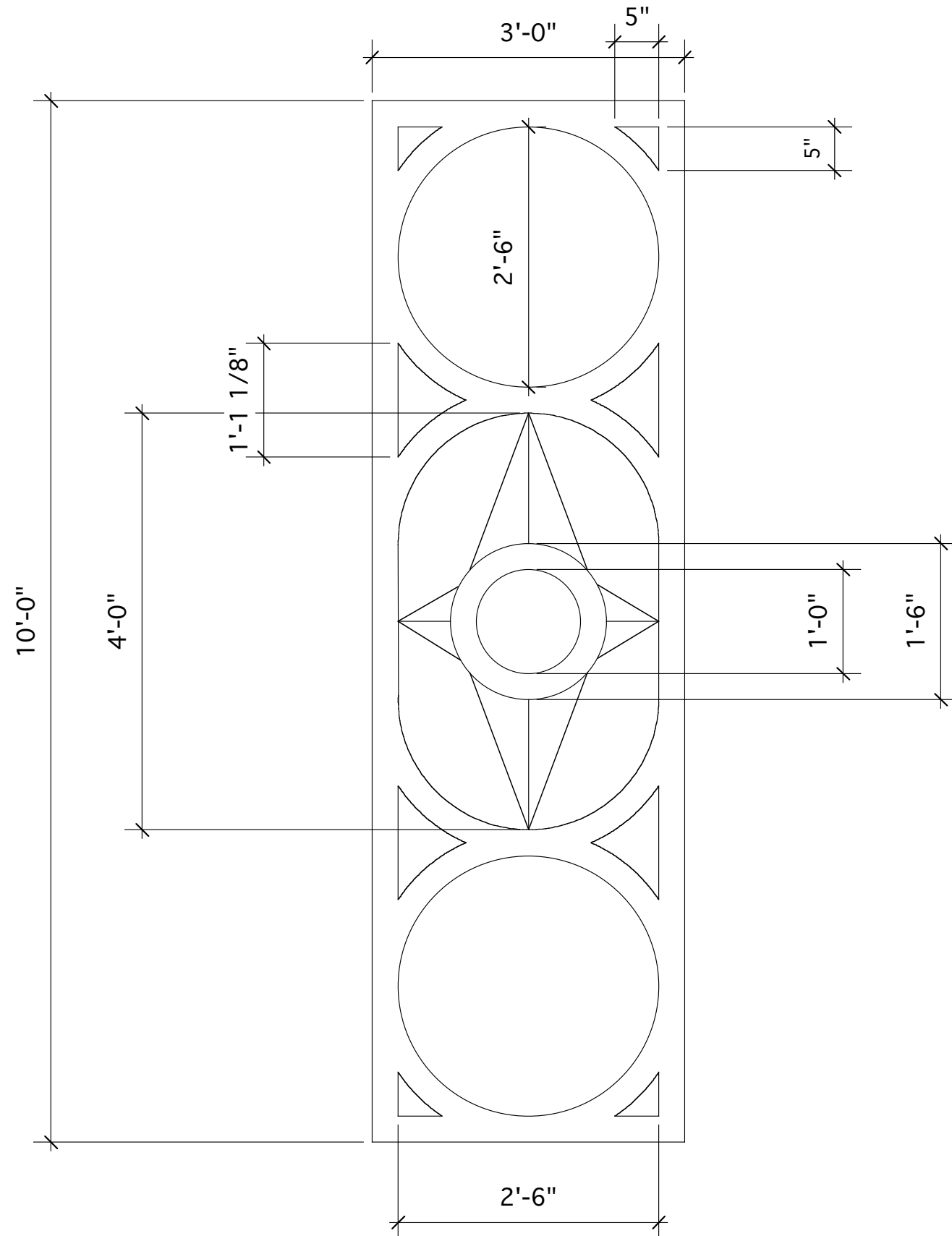

NOTES:

1. The side panels are to be constructed out of lauan in a traditional flat manner.
2. The details on the portal are to be a combination of three dimensional additions of lauan that are adhered to the portal as well as paint finishes.

The Taming of the Shrew	
Written By: William Shakespeare	
Circus Portal Panel Detail	SCALE: 3/4"=1'
Interlochen Shakespeare Festival- Harvey Theatre	
Director: William Church	
Scenic Designer: Christopher S. Dills	
Technical Director: Neil Carpentier-Alting	
Show Date: June 25 - July 5, 2009	
Updated On: 04-16-09	Revision #: 0
11	
of 17	

NOTES:

1. The portal top is to be constructed out of luan in a traditional flat manner.
2. The details on the portal are to be a combination of three dimensional additions of luan that are adhered to the portal as well as paint finishes.

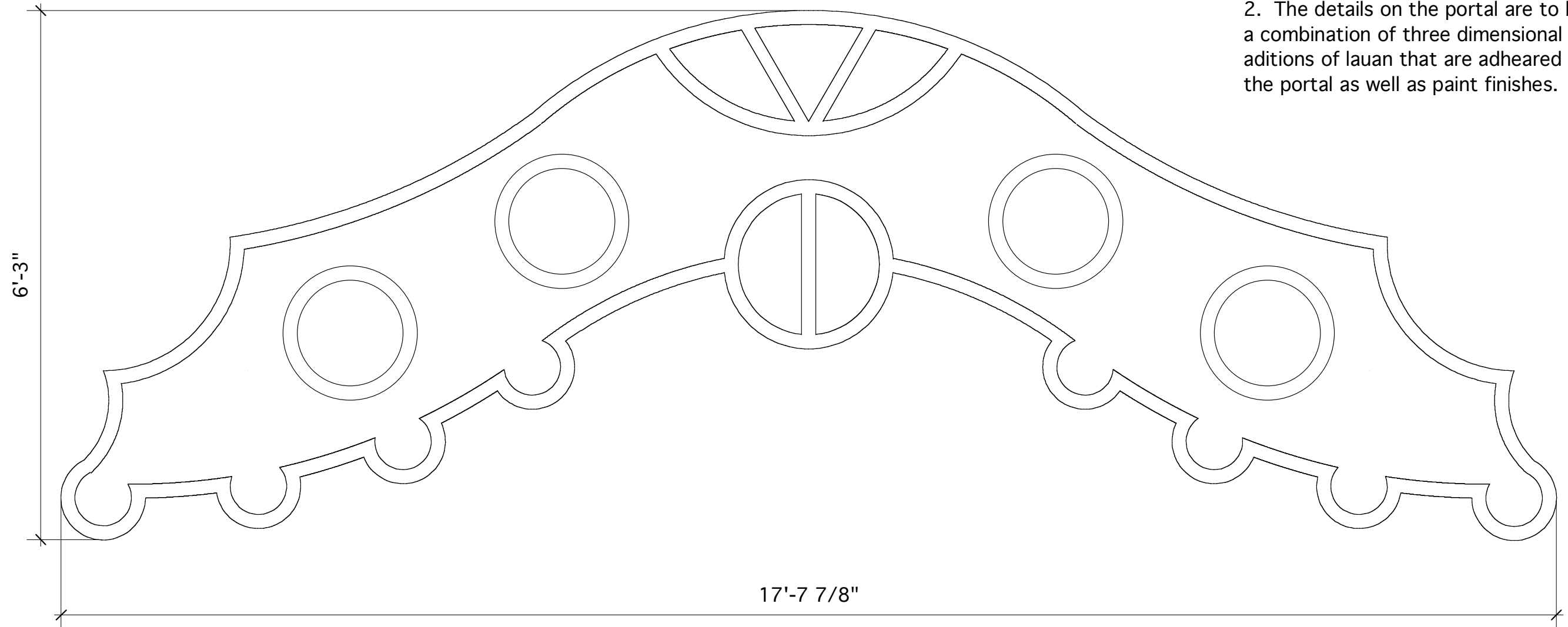

The Taming of the Shrew		
Written By: William Shakespeare		
Circus Portal Top Detail		SCALE: 3/4"=1'
Interlochen Shakespeare Festival- Harvey Theatre		PLATE:
<i>Director: William Church</i>		12
<i>Scenic Designer: Christopher S. Dills</i>		
<i>Technical Director: Neil Carpentier-Alting</i>		
<i>Show Date: June 25 - July 5, 2009</i>		
<i>Updated On: 04-16-09</i>	<i>Revision #: 0</i>	of 17

KNIFE RIG SIDE VIEW

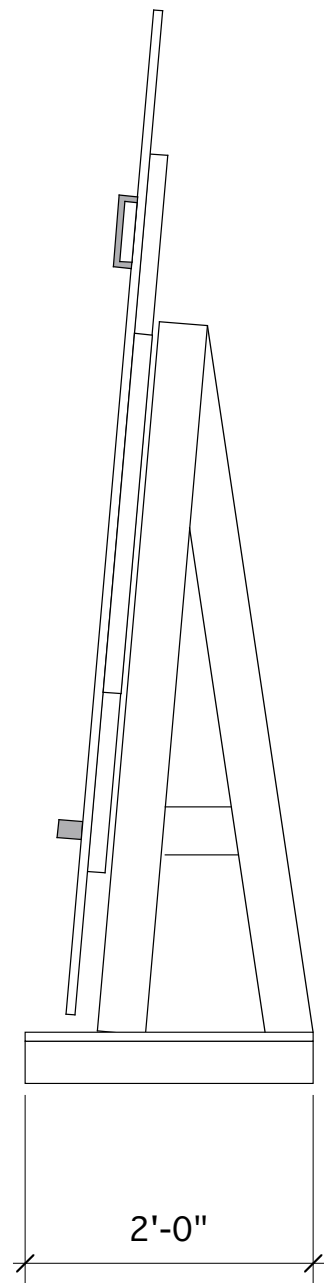

KNIFE RIG ELEVATION

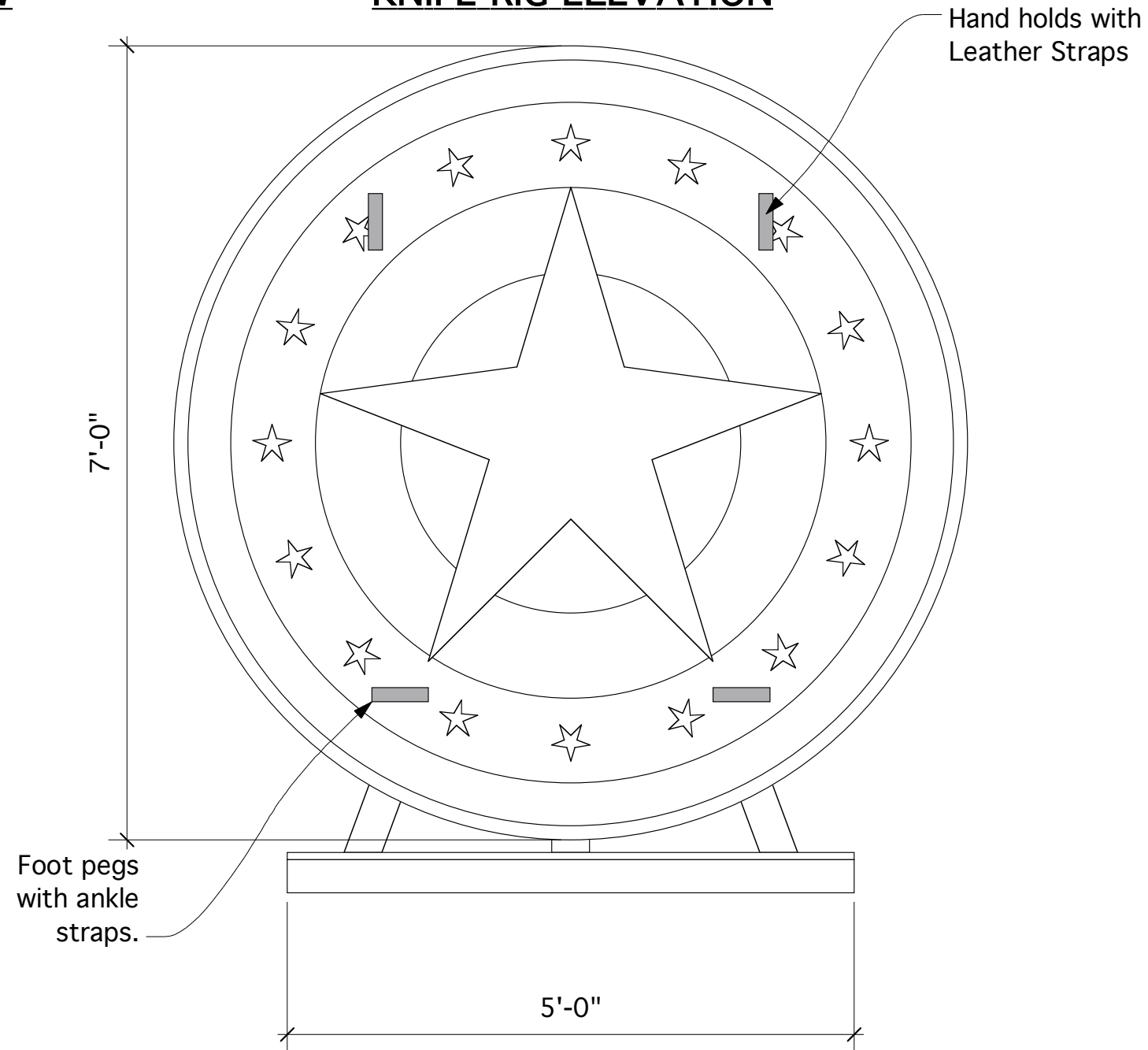

NOTES:

1. The knife throwing rig is to be on wheels for rolling in and out of the circus portal.
2. The entire wheel is to spin on a central axis.
3. Knives are to be rigged to the backside of the unit to spring out on cue.
4. The distance between the wheel and the support structure needs to allow for the knife devices. See pre-existing knife devices from "The Pajama Game".
5. The wheel is to be angled back approximately 5 degrees to assist in keeping the actress against the wheel.
6. The foot pegs are to have ankle straps to help keep the actress on the wheel.
7. The hand holds are to be simple handles that the actress will hold on to. There needs to be straps to tie the actress to the wheel.
8. The knife devices will need to be operated from the backside. This might require additional masking or a box to be constructed to hide the operator. The operator may need to be in this box for an extended period of time (i.e. when the unit is rolled onto the stage until it exits).

The Taming of the Shrew

Written By: William Shakespeare

Knife Throwing Rig Elevation		SCALE: 3/4"=1'
Interlochen Shakespeare Festival- Harvey Theatre		PLATE:
Director: William Church		13
Scenic Designer: Christopher S. Dills		
Technical Director: Neil Carpentier-Alting		
Show Date: June 25 - July 5, 2009		
Updated On: 05-20-09	Revision #: 2	of 17

RING WALL A2

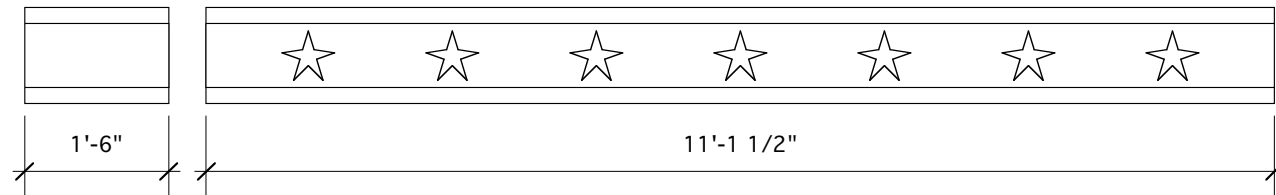

RING WALL A1



RING WALL B2

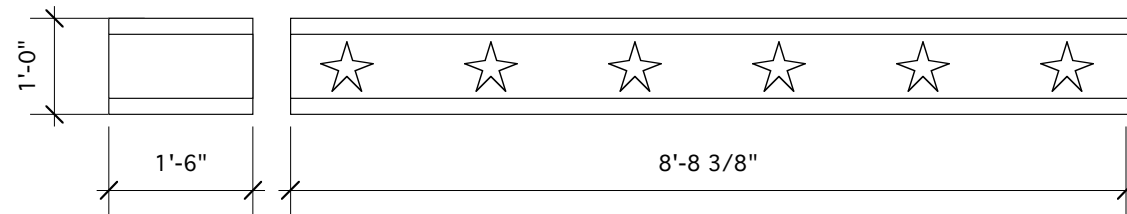

RING WALL B1

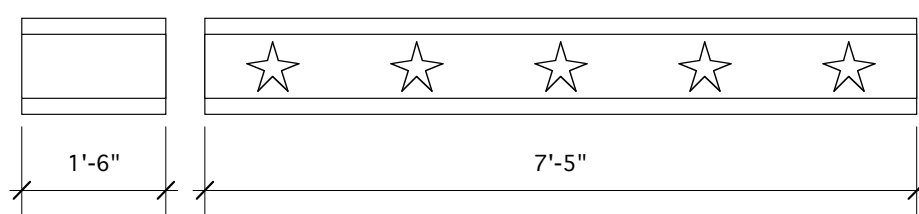

RING WALL C2

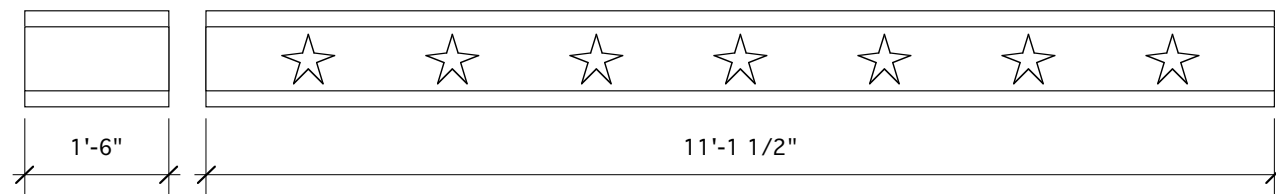

RING WALL C1

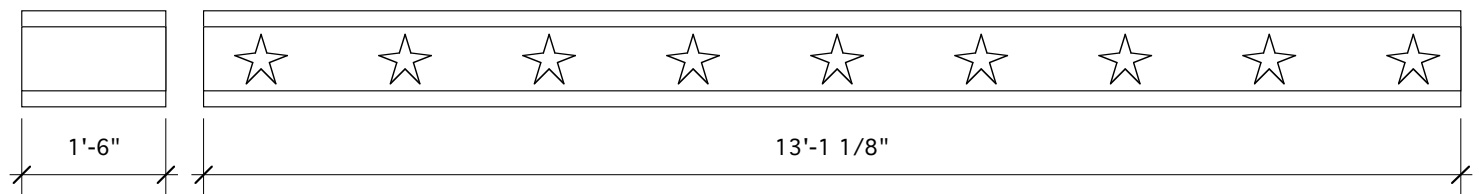

Ground Plan Scale: 1/8"=1'

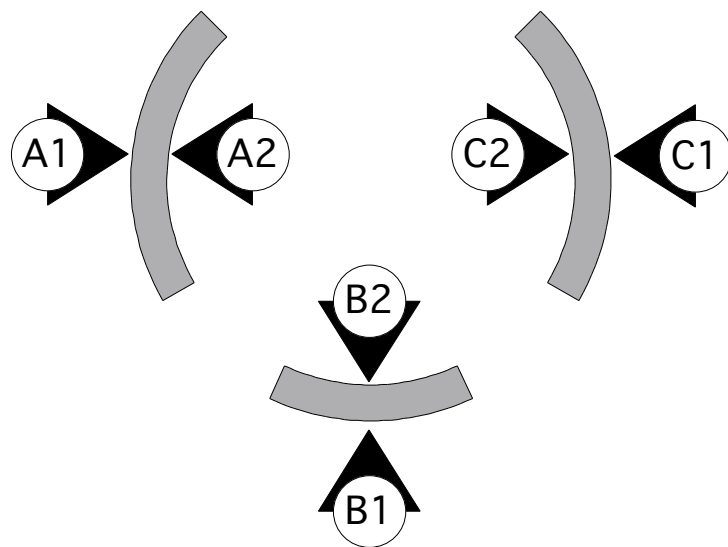

NOTES:

1. Ring section A and C are identical.
2. Along the outside of each ring section is to be attachment points for the rope lines that run to the grid. See plate #1 (ground plan) for specific placements.
3. The sides of the ring units are to be faced with lauan and painted.
4. Each ring unit must be able to be stood upon.
5. Top is to be painted solid red.

The Taming of the Shrew		SCALE: 1/2"=1'
Written By: William Shakespeare		PLATE:
Ring Elevation		14
Interlochen Shakespeare Festival- Harvey Theatre		
Director: William Church		
Scenic Designer: Christopher S. Dills		
Technical Director: Neil Carpentier-Alting		
Show Date: June 25 - July 5, 2009		of 17
Updated On: 05-11-09	Revision #: 3	

CIRCUS RISER
(Facing Paint Detail)

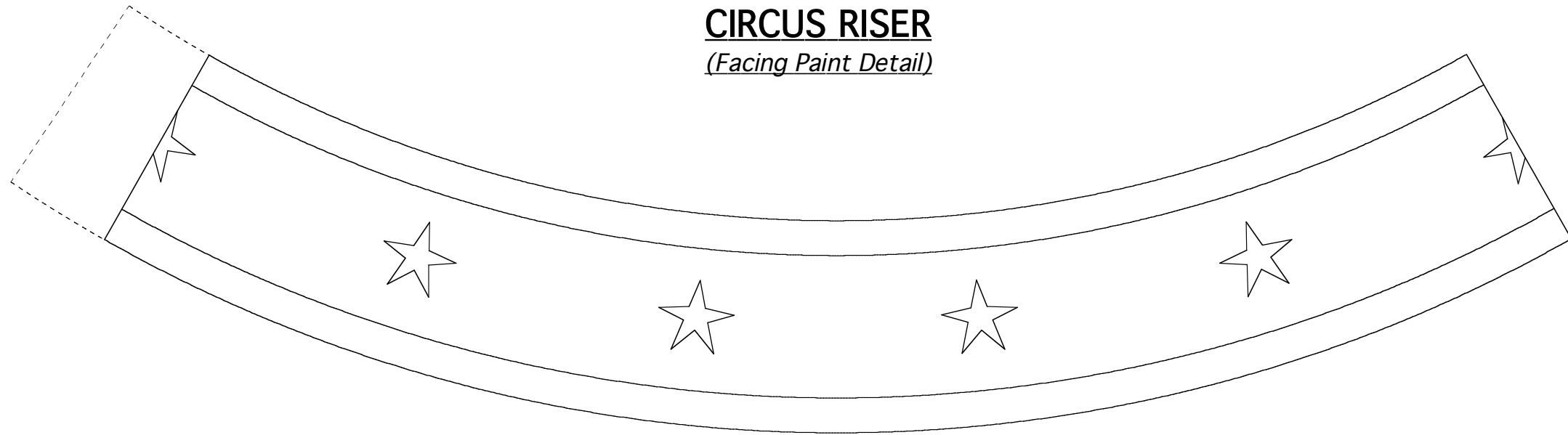

CIRCUS RISER
(Top View Diameters)

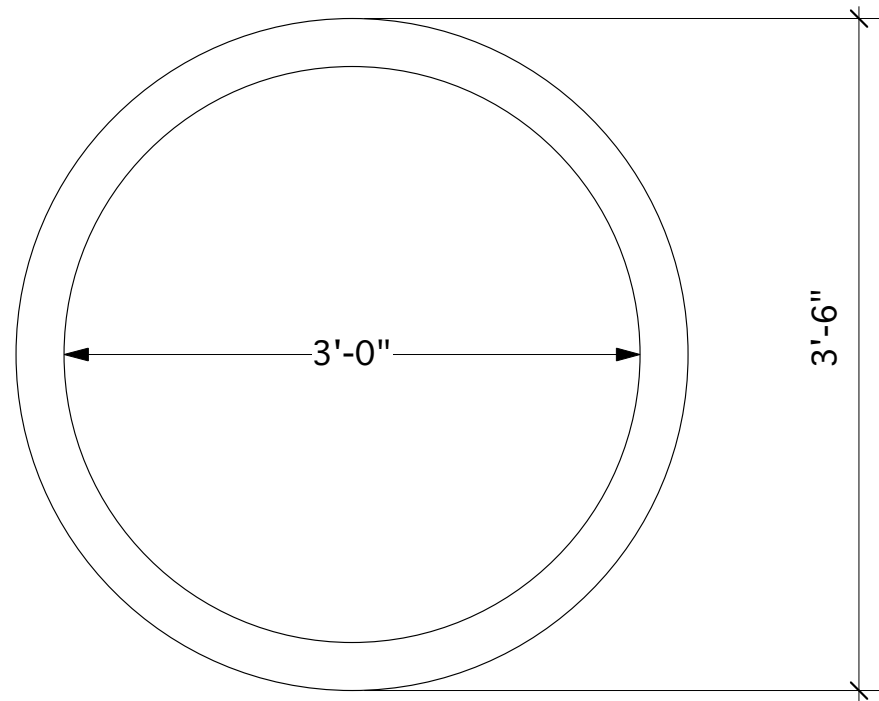

CIRCUS RISER
(Front Elevation)

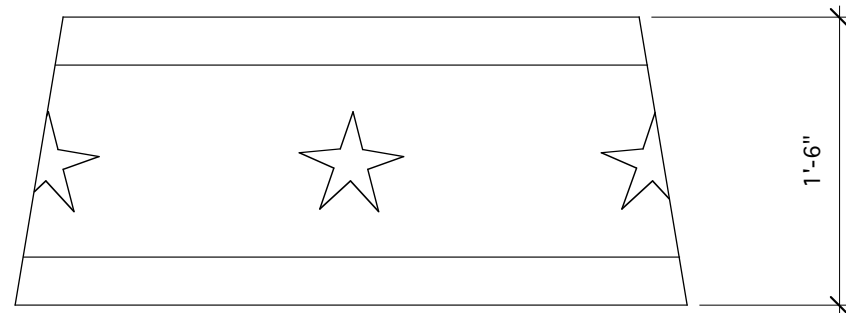

NOTES:

1. The top of the circus riser is narrower than the bottom.
2. The riser is to be on casters to allow them to be moved.
3. The sides of the riser are to be faced with lauan and painted.
4. Must be able to be stood upon.
5. The top is to be painted red.

The Taming of the Shrew	
<small>Written By: William Shakespeare</small>	
Circus Riser Elevation	<small>SCALE: 1"=1'</small>
<small>Interlochen Shakespeare Festival- Harvey Theatre</small>	<small>PLATE:</small>
<small>Director: William Church</small>	15
<small>Scenic Designer: Christopher S. Dills</small>	
<small>Technical Director: Neil Carpentier-Alting</small>	
<small>Show Date: June 25 - July 5, 2009</small>	
<small>Updated On: 05-08-09</small>	<small>Revision #: 1</small>
<small>of 17</small>	

TENT MEDALLION
(Bottom View- Paint Detail)

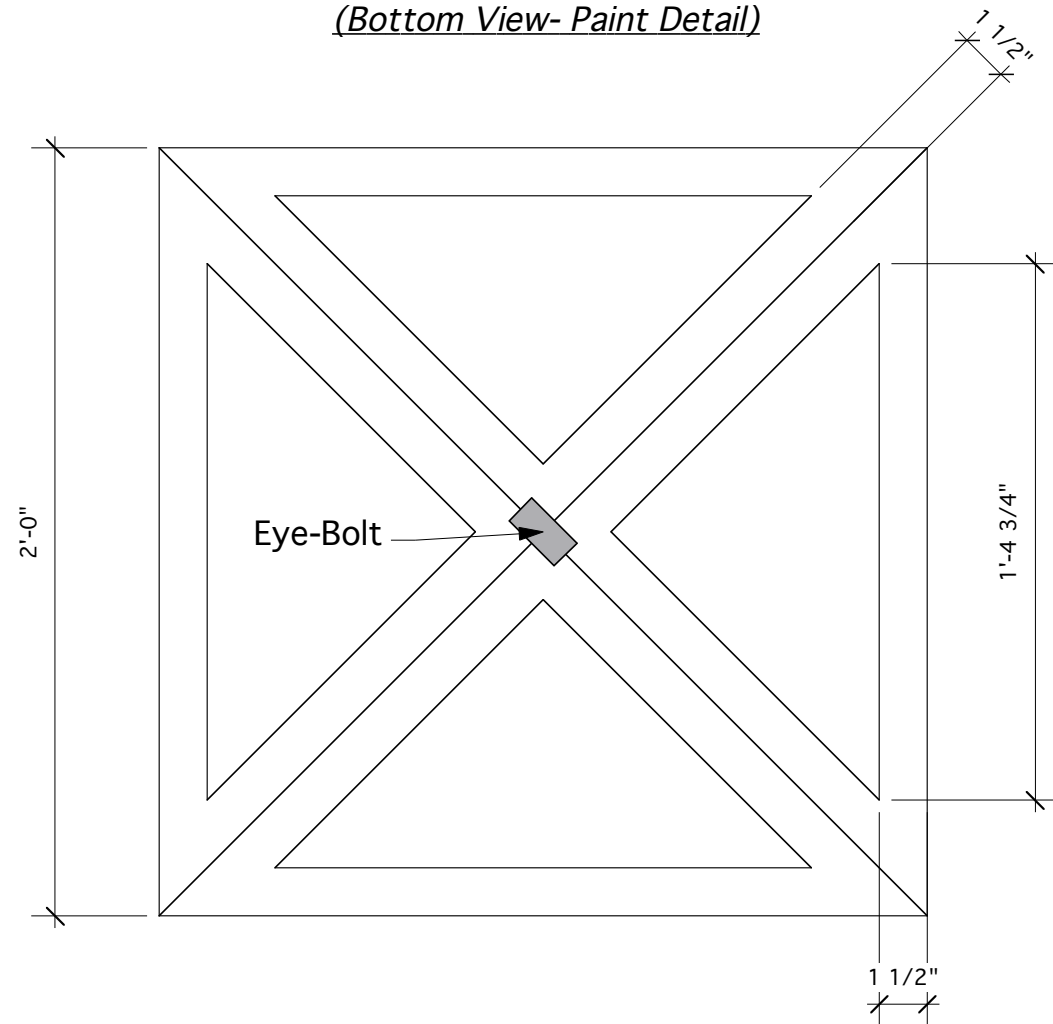

TENT MEDALLION
(Side View- Depth Detail)

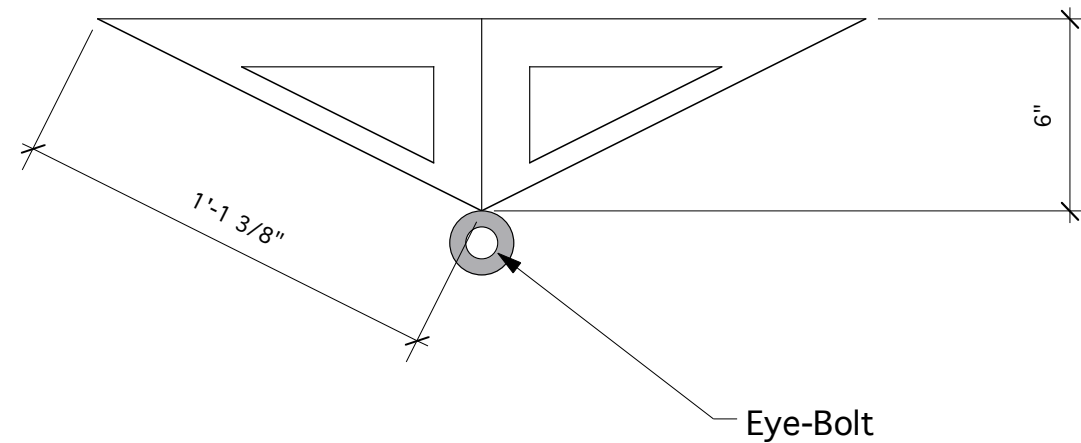

NOTES:

1. Tent medallion is to be attached to the grid and allow for an eye-bolt to be used to affix the guide lines coming from the circus ring to the medallions.
2. They are to be wooden and have depth to them.
3. Actual depth and size can be adjusted if needed for construction purposes.
4. Need to be light-weight, all tension from guide lines are on the eye-bolt which is directly transferred to the grid itself.

The Taming of the Shrew	
<small>Written By: William Shakespeare</small>	
Tent Medallion Plans	<small>SCALE: 2"=1'</small>
<small>Interlochen Shakespeare Festival- Harvey Theatre</small>	<small>PLATE:</small>
<small>Director: William Church</small>	16
<small>Scenic Designer: Christopher S. Dills</small>	
<small>Technical Director: Neil Carpentier-Alting</small>	
<small>Show Date: June 25 - July 5, 2009</small>	
<small>Updated On: 05-11-09</small>	<small>Revision #: 1</small>
<small>of 17</small>	

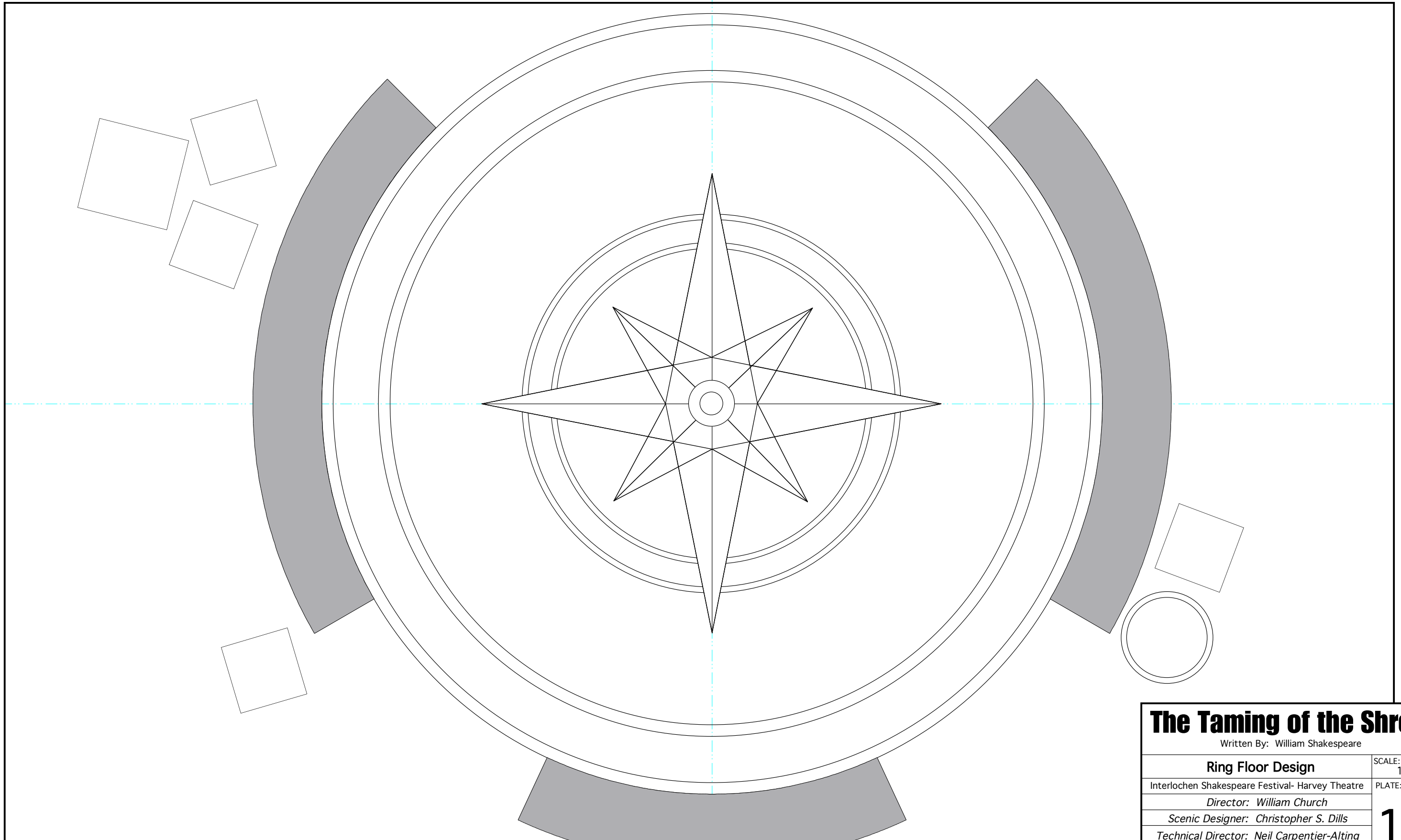

The Taming of the Shrew	
Written By: William Shakespeare	
Ring Floor Design	SCALE: 1/2"=1'
Interlochen Shakespeare Festival- Harvey Theatre	PLATE:
<i>Director: William Church</i>	17
<i>Scenic Designer: Christopher S. Dills</i>	
<i>Technical Director: Neil Carpentier-Alting</i>	
<i>Show Date: June 25 - July 5, 2009</i>	of 17
<i>Updated On:</i> 05-14-09 <i>Revision #:</i> 1	



NOTES:

1. The top and side panels are to be constructed out of lauan in a traditional flat manner.
2. The details on the portal are to be a combination of three dimensional additions of lauan that are adhered to the portal as well as paint finishes.
3. The curtain should be of a velour type of material that has seen better days.
4. The curtain should open diagonally from the center. It should be operated from a pulley system located on the upstage side of the portal just stage right or left of the opening. It should be able to be operated by one person.

The Taming of the Shrew

Written By: William Shakespeare

Circus Portal Front Elevation #1

SCALE: 1/2"=1'

Interlochen Shakespeare Festival- Harvey Theatre

PLATE:

Director: William Church

Scenic Designer: Christopher S. Dills

Technical Director: Neil Carpentier-Alting

Show Date: June _____, 2009

Updated On: 04-16-09

Revision #: 0

10

of 15

KNIFE RIG SIDE VIEW

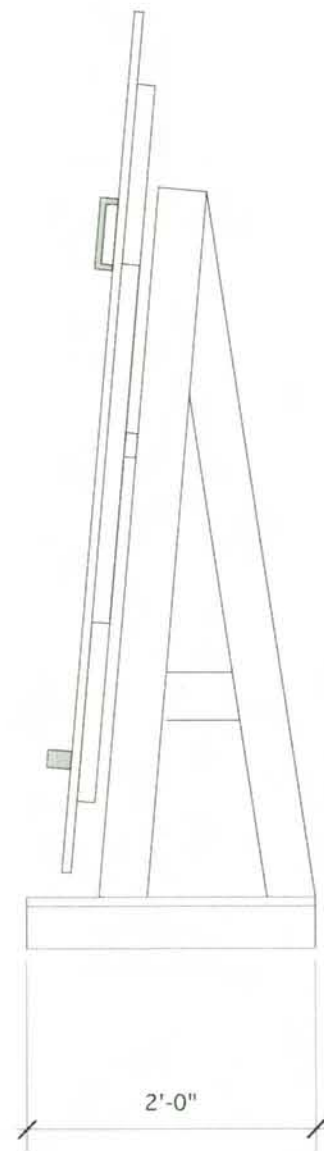

KNIFE RIG ELEVATION

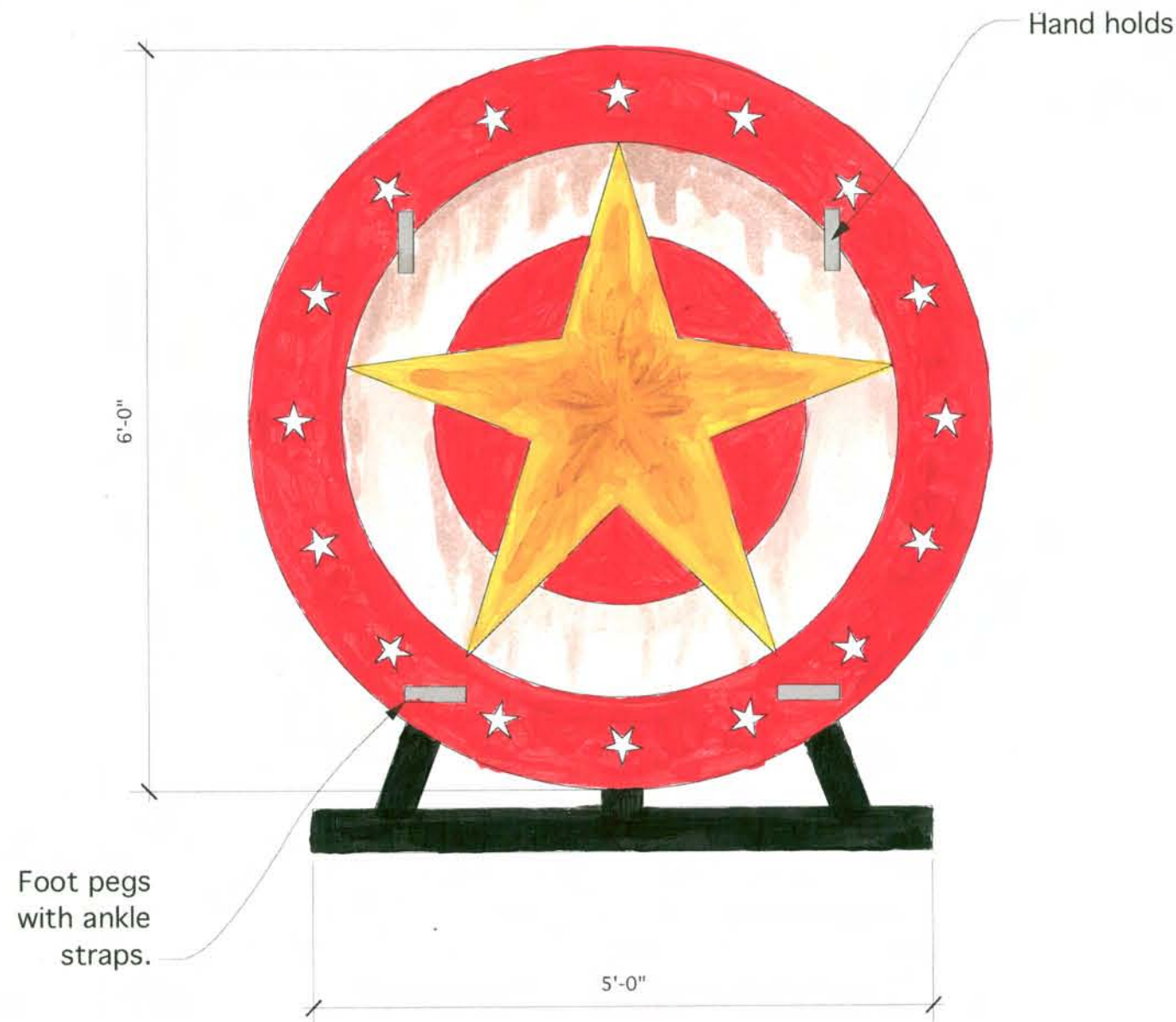

NOTES:

1. The knife throwing rig is to be on wheels for rolling in and out of the circus portal.
2. The entire wheel is to spin on a central axis.
3. Knives are to rigged to the backside of the unit to spring out on cue.
4. The distance between the wheel and the support structure needs to allow for the knife devices. See pre-existing knife devices from "The Pajama Game".
5. The wheel is to be angled back approximately 5 degrees to assist in keeping the actress against the wheel.
6. The foot pegs are to have ankle straps to help keep the actress on the wheel.
7. The hand holds are to be simple handles that the actress will hold on to.
8. The knife devices might need to be operated from the backside. This might keep the wheel from spinning as it would be impossible for someone to pull a pin to release a spring loaded knife.

The Taming of the Shrew

Written By: William Shakespeare

Knife Throwing Rig Elevation

SCALE:
3/4"=1'

Interlochen Shakespeare Festival- Harvey Theatre

PLATE:

Director: William Church

Scenic Designer: Christopher S. Dills

Technical Director: Neil Carpentier-Alting

Show Date: June _____, 2009

Updated On: 04-29-09

Revision #: 0

13

of 15

RING WALL A2

RING WALL A1

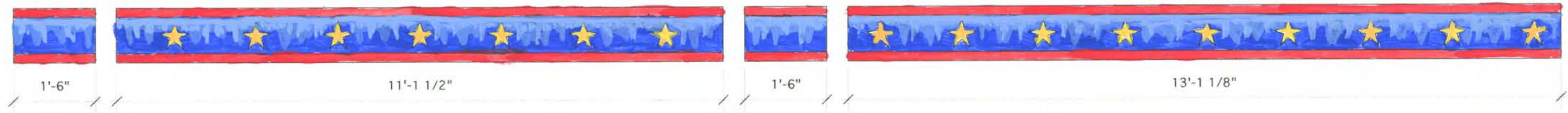

RING WALL B2

RING WALL B1



RING WALL C2

RING WALL C1

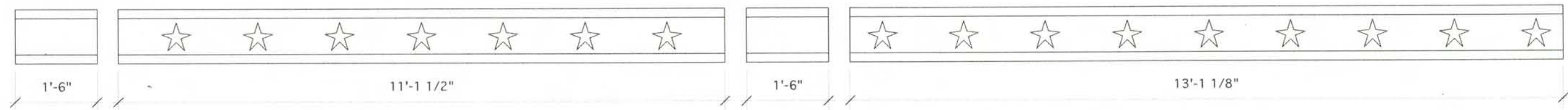

Ground Plan Scale: 1/8"=1'

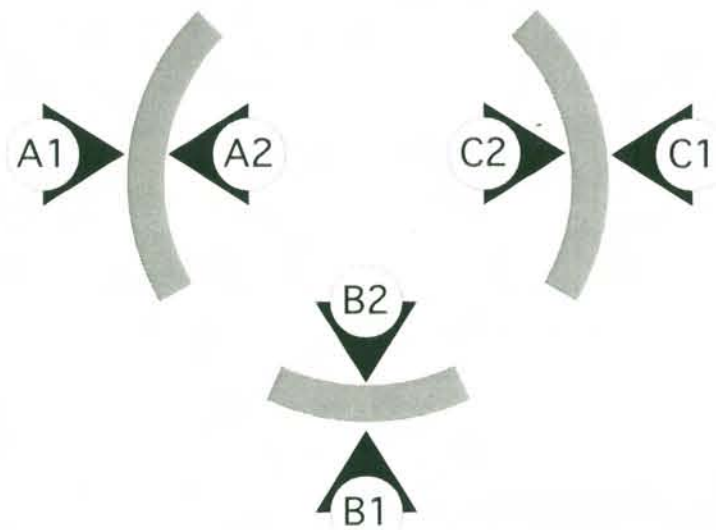

NOTES:

1. Ring section A and C are identical.
2. Along the outside of each ring section is to be attachment points for the rope lines that run to the grid. See plate #1 (ground plan) for specific placements.
3. The sides of the ring units are to be faced with lauan and painted.
4. Each ring unit must be able to be stood upon.
5. Top is to be painted solid red.

The Taming of the Shrew

Written By: William Shakespeare

Ring Elevation	SCALE: 1/2"=1'
Interlochen Shakespeare Festival- Harvey Theatre	PLATE:
Director: William Church	14
Scenic Designer: Christopher S. Dills	
Technical Director: Neil Carpentier-Alting	
Show Date: June 25 - July 5, 2009	
Updated On: 05-11-09	Revision #: 3 of 16

CIRCUS RISER
(Facing Paint Detail)



CIRCUS RISER
(Top View Diameters)

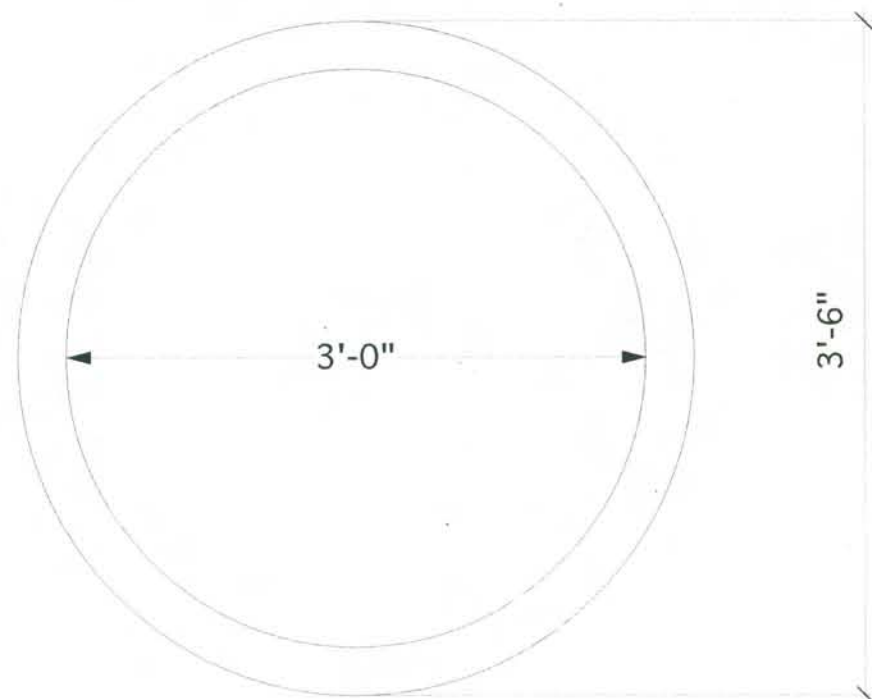

CIRCUS RISER
(Front Elevation)



NOTES:

1. The top of the circus riser is narrower than the bottom.
2. The riser is to be on casters to allow them to be moved.
3. The sides of the riser are to be faced with lauan and painted.
4. Must be able to be stood upon.
5. The top is to be painted red.

The Taming of the Shrew

Written By: William Shakespeare

Circus Riser Elevation	SCALE: 1"=1'
Interlochen Shakespeare Festival- Harvey Theatre	PLATE:
Director: William Church	15
Scenic Designer: Christopher S. Dills	
Technical Director: Neil Carpentier-Alting	
Show Date: June 25 - July 5, 2009	
Updated On: 05-08-09	Revision #: 1

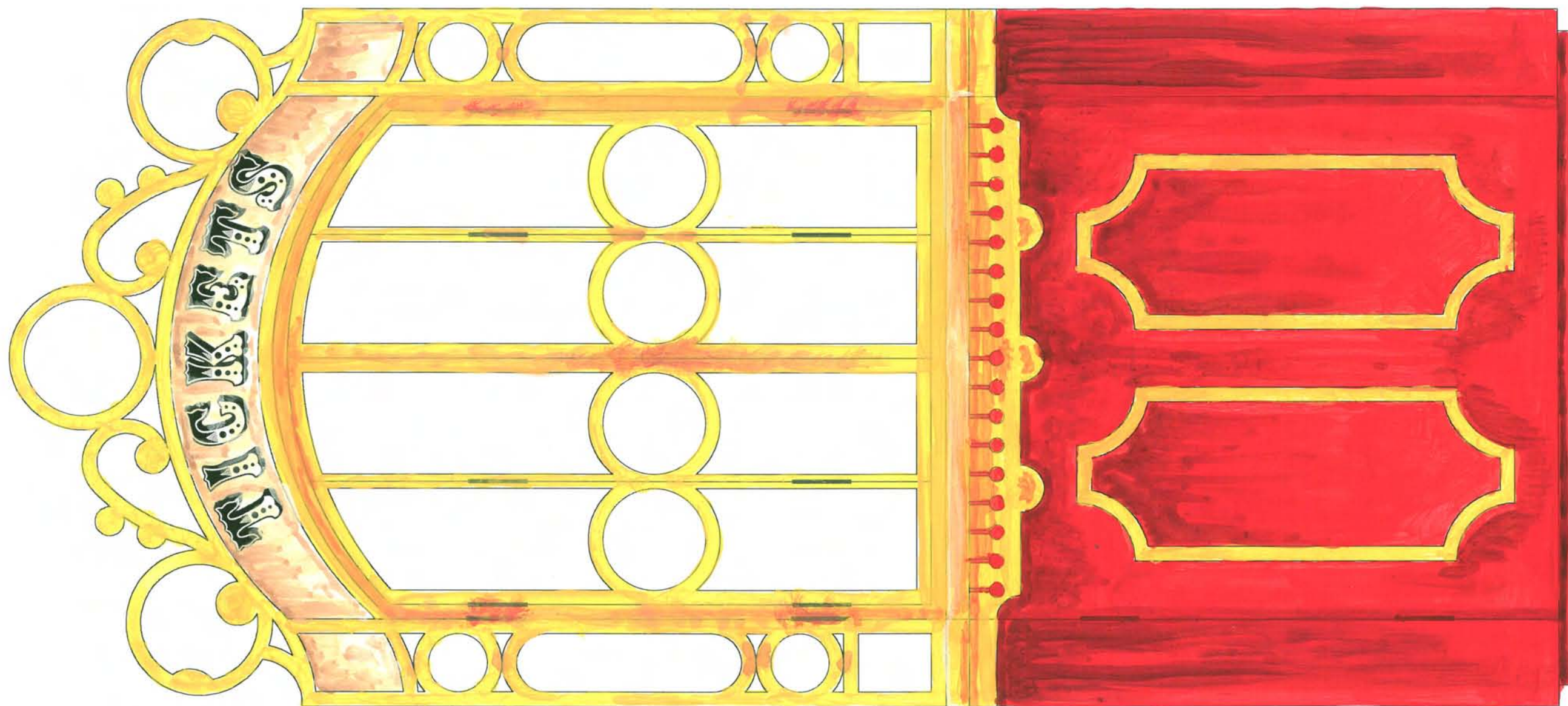

The Taming of the Shrew

Written By: William Shakespeare

T. Booth Front Elevation (Large)

SCALE:
1.5"=1'

Interlochen Shakespeare Festival- Harvey Theatre

PLATE:

Director: William Church

Scenic Designer: Christopher S. Dills

Technical Director: Neil Carpentier-Alting

5B

Show Date: June _____ - _____, 2009

Updated On: 4-30-09

Revision #: 0

of 15